

**Registered**  
**Land Area 257.2m<sup>2</sup>**  
**Frontage Cnr/ 15m<sup>2</sup>**

**Package Price**  
**\$967,000**



***Lot 1/19 Twenty Eight Avenue Austral***

**LAND PRICE**  
**\$585,000**

**HOUSE PRICE**  
**\$382,000**

## STAMFORD 3

### Inclusions:

- ✓ Ceramic tiling to Porch, Entry, Dining / Family
- ✓ Natural Gas Package - inc Rheem Instantaneous HWS
- ✓ Insulation to ceiling & walls
- ✓ Colourbond Roofing
- ✓ Natural Coloured Driveway
- ✓ 20mm Caesarstone benchtop to kitchen
- ✓ 600mm European stainless steel appliances
- ✓ Freestanding Bath
- ✓ **PEACE OF MIND INCLUSIONS PACKAGE**  
\* For full inclusions visit our website at [www.codehomes.com.au](http://www.codehomes.com.au)

## 3BED 2BATH 1CAR

Quality Inclusions. Quality Brands

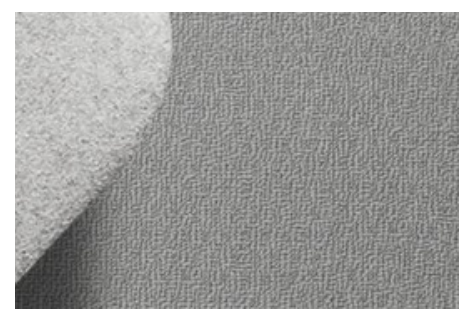

 **caesarstone®**

 **Bradnam's**  
windows & doors

 **HUME DOORS & TIMBER**  
100% Australian Owned

 **australbricks®**

 **LANE**  
SECURITY - STYLE - FUNCTION

**Head Office: 02 9627 4191 Sales: 0409 613 059 [www.codehomes.com.au](http://www.codehomes.com.au) [sales@codehomes.com.au](mailto:sales@codehomes.com.au)**

Disclaimer: All plans, images, and areas are indicative only. The finishes to the nominated design are to be used as a guide only. Buyers are advised to refer to the land contract and or builders tender and contract for precise specifications and inclusions. Code Homes reserves the right to change, specifications, materials and suppliers. Builders Licence: 217700c



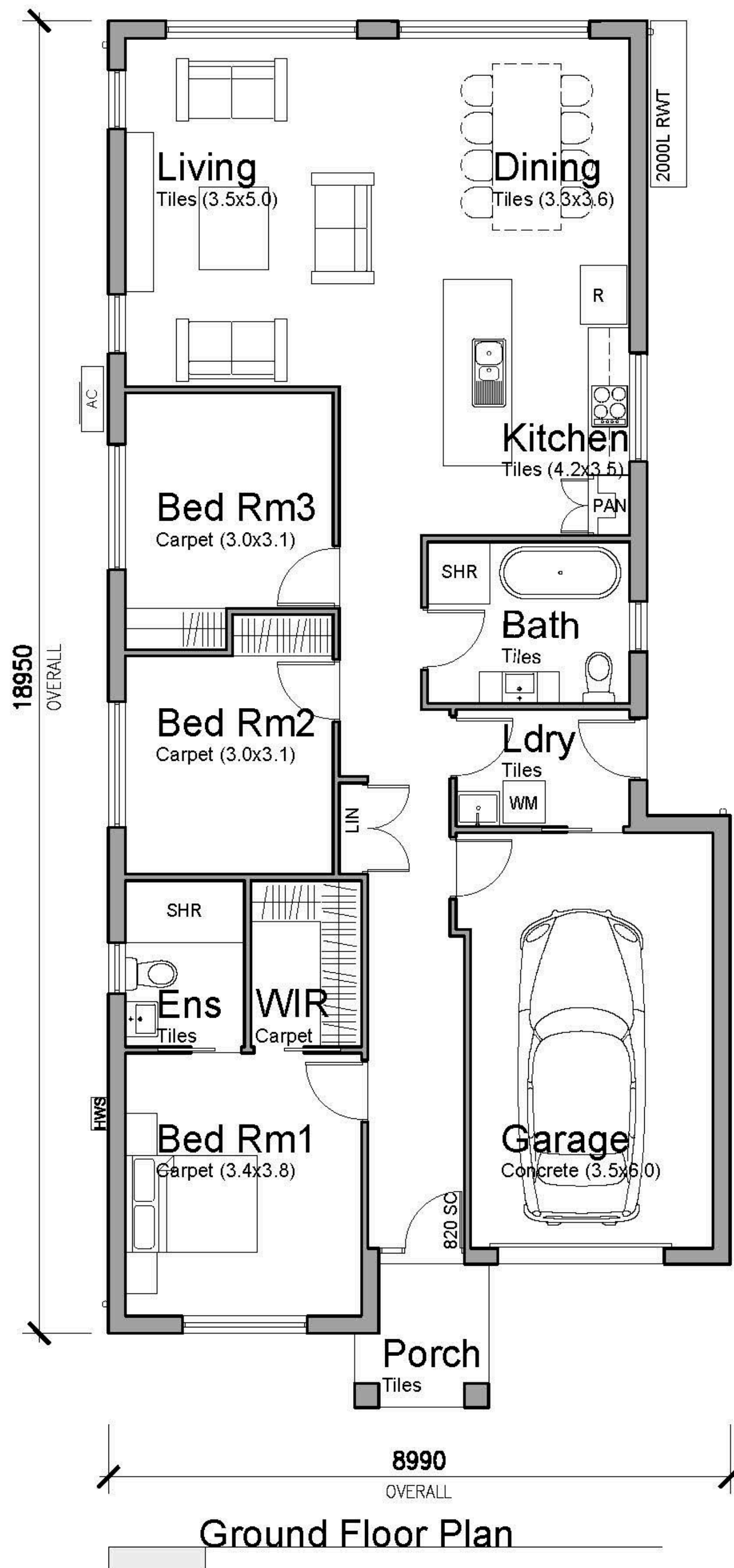

## STAMFORD 3 139.7m<sup>2</sup> (15.04 squares)

1. Floor Area (incl Garage)	139.7m <sup>2</sup>
-----------------------------	---------------------

Min Lot Size: 10m x 26.5m

Min Frontage: 10m